



SHORT DISC HARROW GEKON



2,75 - 6,25 m



from 100 hp



up to 20 km/h

SHORT DISC HARROW GEKON



The GEKON short disc harrow provides intensive mixing of soil and plant mass to a depth of 15 cm. The design and placement of working bodies provides high-quality pre-sowing treatment, efficient stubble cultivation and stubble peeling. GEKON guarantees the best mulching of crop residues and prevents the formation of compacted soil layers. All this contributes to the formation of high-quality soil structure, provides optimal water-air regime.

SERIES GEKON

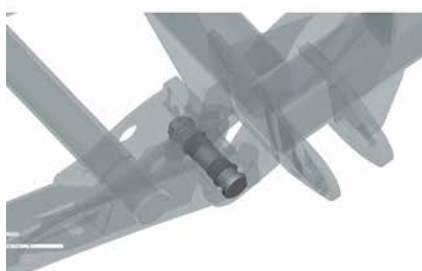

MAINTENANCE-FREE

Due to securely sealed bearing assemblies and high-quality plain bearings used in every hitched connection, GEKON disk harrows do not have any lubrication points.

There is no need to purchase lubricants or spend time to maintain the unit.

All is needed to start working is only tillage depth adjustment!



SPRING RACK

A spring hanger provides protection of the bearing assembly and smooth tillage. Using it reduces the traction resistance of the implement (thus saves fuel).



LARGE-DIAMETER ROLLER WITHOUT A CENTRAL PIN

500 mm cage roller provides reliable uniform depth of work of the unit even on light soils.

Absence of a central pin makes the roller resistant to clogging in the moist soil conditions and extremely contaminated field.

SHORT DISC HARROW GEKON

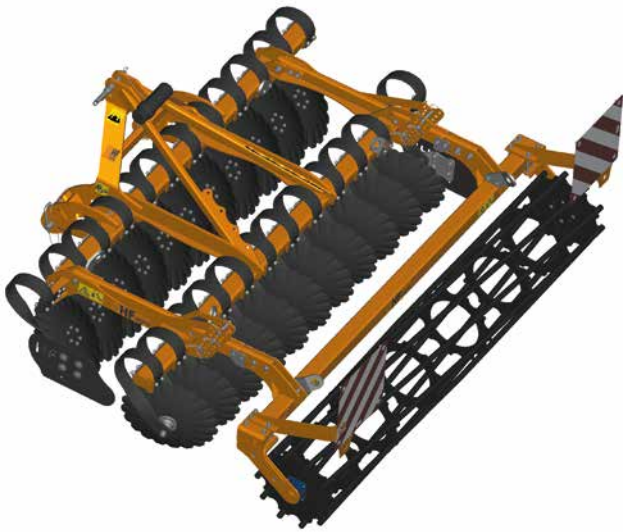

EASY TRANSPORTATION

Due to the special arrangement of working tools, the unit, with its width of capture, fits into a transport width of 3 m without the additional folding of the outermost racks.



MULTI-PURPOSE ATTACHMENT SYSTEM

The attachment system is adapted to categories 2 and 3 three-point hitch, and is supplied complete with all the necessary components.

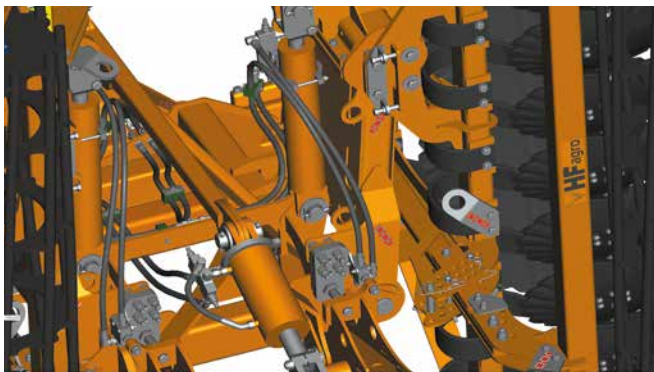

AUTOMATIC LOCKING OF THE UNIT IN THE TRANSPORT POSITION

An operator neither needs to leave the tractor cab, nor pay attention to locking/unlocking the transport stops during assembly/disassembly of the unit.

Unproductive time spent during the operation of the unit is thus reduced. The possibility of an operator's error in removing the stoppers and corresponding unit damage is eliminated.

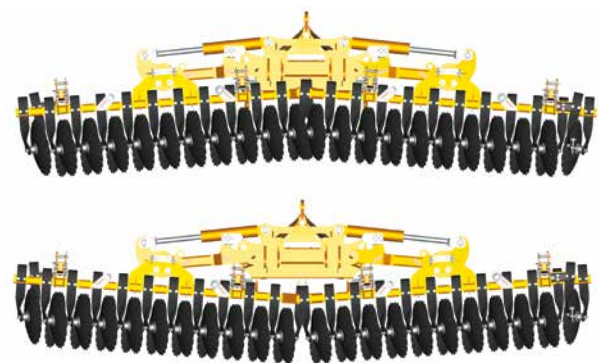

INNOVATIVE CONTOUR FOLLOWING SYSTEM

The contour following system with centrally suspended working sections evenly distributes weight of the unit along its whole width of capture, thus enabling the even depth of tillage.

The use of rubber dampers in the system allows for additional pressure at the edges of the half-frames when following the field on uneven sites.

Therefore, not only does the unit follow the field's contour, it also levels its surface!

SHORT DISC HARROW GEKON

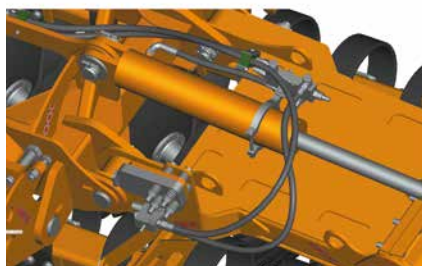

DISASSEMBLY SYSTEM WITH HYDRAULIC PROTECTION

Availability of additional protective elements in the hydraulic system prohibits an operator from violating the assembly/disassembly sequence of the unit.

Therefore, the risk of damage to the unit design due to human factors is reduced.



TRANSITION TO THE HINGED DESIGN

The central frame of the unit is equipped with the integrated adapter for category 3/4N three-point hitch which allows using the unit in the hinged design, after detaching a hitch frame and a running gear.



HYDRAULIC ADJUSTMENT OF THE HITCH FRAME POSITION

The unit's horizontal position is adjusted by means of the hydraulic cylinder of a hitch frame with the remote plates built into the frame.

The set-up requires minimum time; and no significant physical effort. The remote plates can't be lost in a field and are kept safely in place.

TECHNICAL DATA

	GEKON-3	GEKON-4	GEKON-5	GEKON-6
Width of capture, m	2,75	4	5,25	6,25
Power of a tractor, hp	100	130	150	170
Aggregation	mounted		semi-trailed	
Weight, kg	1336	1669	3988	4402
Number of disks, pc	22	32	42	50
Disk diameter, mm	568			
Number of hydraulic pairs, pc	-		2	
Depth of cultivation, cm	3-12		3-15	
Maximum working speed, km/h	up to 20			
Overall dimensions in transport position (length, width, height), mm	2489x3000x1700	2489x4402x1700	5612x3000x3324	5612x3000x3824